

# Reggisella/Seatposts Ricambi/Spare Parts

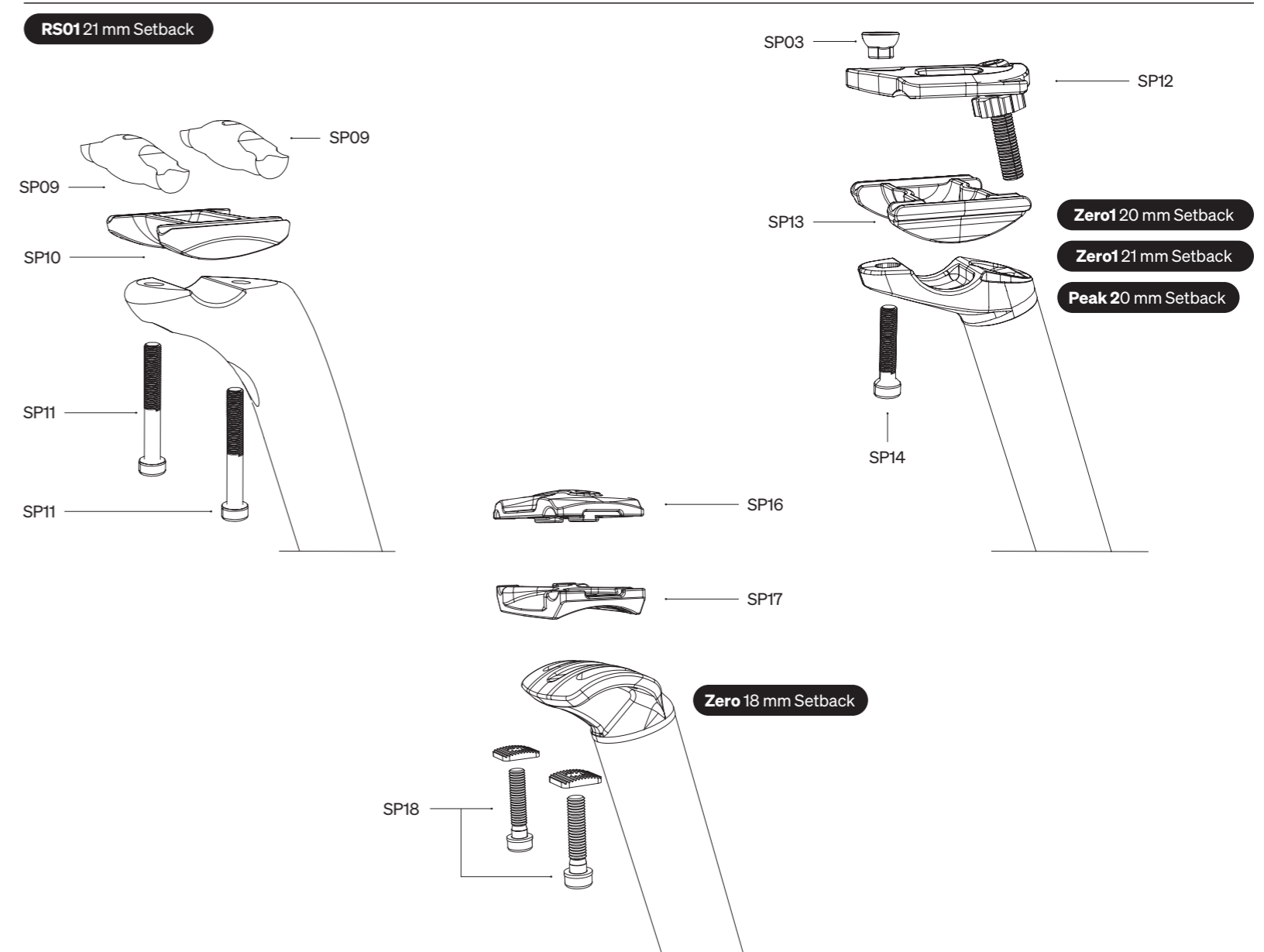
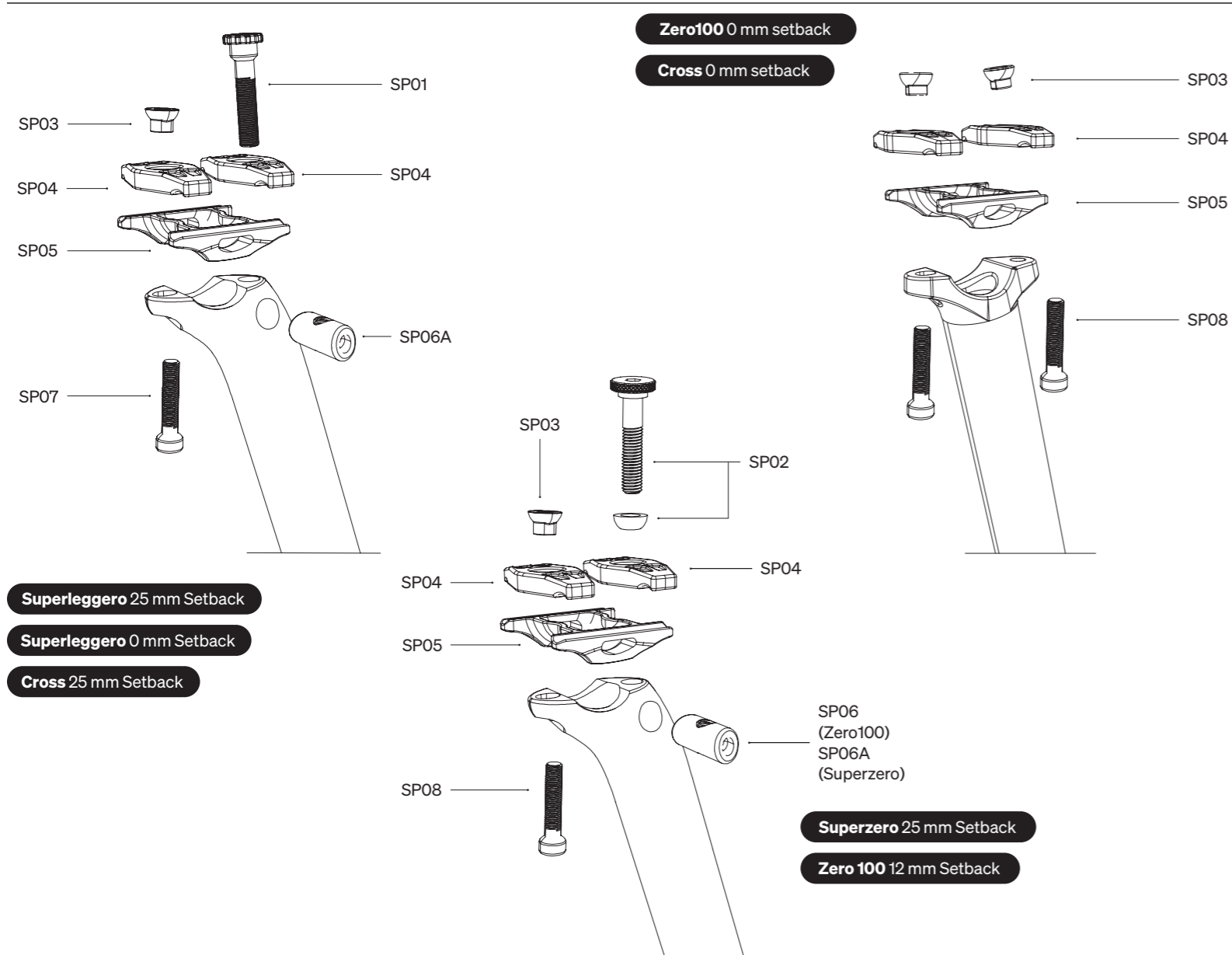

| Deda Part | Description  | Material | Finish        | Superleggero | Superzero | Zero100 |
|-----------|--|----------|---------------|--------------|-----------|---------|
|           |  |          |               | 25 & 0 mm    | 25 mm     | 0 mm    |
| SP01      | Seatpost Fixing Bolt M7x30 mm Titanium                           | Titanium | Titanium      | Y            | -         | -       |
| SP02      | Seatpost Fixing Bolt, M7x35 mm, w/convex washer, stainless steel | Steel    | Chrome Plated | -            | Y         | -       |
| SP03      | Seatpost End-Nut (1 Piece)                                       | Steel    | Chrome Plated | Y            | Y         | Y       |
| SP04      | Seatpost Upper Plate   | Alloy    | Black         | Y            | Y         | Y       |
| SP05      | Seatpost Lower Plate   | Alloy    | Black         | Y            | Y         | Y       |
| SP06      | Seatpost Barrel Nut  | Alloy    | Black         | -            | -         | -       |
| SP06A     | Seatpost Barrel Nut  | Alloy    | Black         | Y            | Y         | -       |
| SP07      | Seatpost Fixing Bolt, M6x28 mm, black PVD, titanium              | Titanium | Titanium      | Y            | -         | -       |
| SP08      | Seatpost Fixing Bolt, M6x28 mm, steel                            | Steel    | Chrome Plated | -            | Y         | Y       |
| SP09      | Cylinder Upper Plate (1 Piece)                                   | Alloy    | Silver        | -            | -         | -       |
| SP10      | Seatpost Lower Plate   | Alloy    | Silver        | -            | -         | -       |
| SP11      | Seatpost Fixing Bolt M6x40 mm Steel                              | Steel    | Chrome Plated | -            | -         | -       |
| SP12      | Upper Plate Kit (Including Bolt)                                 | -        | -             | -            | -         | -       |
| SP13      | Seatpost Lower Plate   | Alloy    | Black         | -            | -         | -       |
| SP14      | Seatpost Fixing Bolt M6 x 25 mm Steel                            | Steel    | Chrome Plated | -            | -         | -       |
| SP16      | Seatpost Upper Plate (Zero)                                      | Alloy    | Black         | -            | -         | -       |
| SP17      | Seatpost Upper Plate (Zero)                                      | Alloy    | Black         | -            | -         | -       |
| SP18      | Seatpost Fixing Bolt & Nut, M6x28 mm, steel, 1Pc (Zero)          | Steel    | Chrome Plated | -            | -         | -       |

| Zero100 | Zero2 | Zero1 | Zero  | RS01  | Cross | Cross | Peak  |
|---------|-------|-------|-------|-------|-------|-------|-------|
| 12 mm   | 21 mm | 20 mm | 18 mm | 21 mm | 0 mm  | 25 mm | 20 mm |
| -       | -     | -     | -     | -     | -     | Y     | -     |
| Y       | -     | -     | -     | -     | -     | -     | -     |
| Y       | -     | -     | -     | -     | Y     | Y     | Y     |
| Y       | -     | -     | -     | -     | Y     | Y     | -     |
| Y       | -     | -     | -     | -     | -     | -     | -     |
| -       | -     | -     | -     | -     | -     | Y     | -     |
| -       | -     | -     | -     | -     | -     | Y     | -     |
| Y       | -     | -     | -     | -     | Y     | -     | -     |
| -       | Y     | Y     | -     | -     | -     | -     | Y     |
| -       | Y     | Y     | -     | -     | -     | -     | Y     |
| -       | Y     | Y     | -     | -     | -     | -     | Y     |
| -       | -     | -     | Y     | -     | -     | -     | -     |
| -       | -     | -     | Y     | -     | -     | -     | -     |
| -       | -     | -     | Y     | -     | -     | -     | -     |